

CAT

Pany inox. amb brides dobles

E

Cierre inox. con bridas dobles

F

Fermeture inox. avec colliers doubles

GB

Stainless steel closure with double collars

D

Edelstahlgriff mit doppelten Drehstangenführungen

NL

RVS-handgreep met dubbele draaistangeleidingen

I

Chiusura acciaio inox con linguette doppie

P

Fecho em aço inoxidável com flanges duplas



Ø 27 mm



Inoxidables Manufactures i Qualitat s.l.

Tel.: 977 704 835 / Fax: 977 704 279
Apart. 237 - Partida Comes, s/n
43870 AMPOSTA (Tarragona)

E-mail: imiq@imiq.cat

www.imiq.cat

2 u. **CRP2701**

- Cremona Ø 27
- Cremona Ø 27
- Gâche Ø 27
- Striking plate Ø 27
- Drehhakenhalter Ø 27
- Draaihaaksteun Ø 27
- Bocchetta Ø 27
- Cremona Ø 27

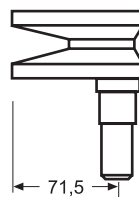
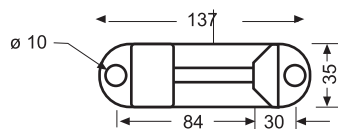

2 u. **LLP2701**

- Lleba Ø 27
- Leva Ø 27
- Pêne Ø 27
- Lever Ø 27
- Drehhaken Ø 27
- Draaihaak Ø 27
- Chiavistello Ø 27
- Came Ø 27

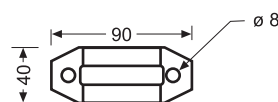
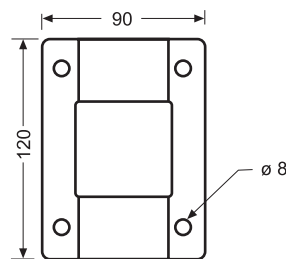

2 u. **BRP2702**

- Brida doble Ø 27
- Brida doble Ø 27
- Collier double Ø 27
- Double collar Ø 27
- Doppelte Drehstangenführung Ø 27
- Dubbele draaistanggeleiding Ø 27
- Linguetta doppia Ø 27
- Flange dupla Ø 27

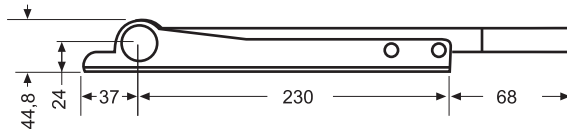
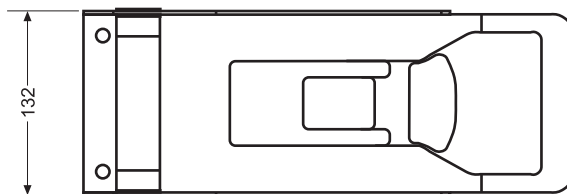

1 u. **BRP2701**

- Brida senzilla Ø 27
- Brida simple Ø 27
- Collier simple Ø 27
- Single collar Ø 27
- Einfache Drehstangenführung Ø 27
- Enkelvoudige draaistanggeleiding Ø 27
- Linguetta semplice Ø 27
- Flange simples Ø 27



1 u. **MNP2701**

- Maneta Ø 27
- Maneta Ø 27
- Poignée Ø 27
- Handle Ø 27
- Handgriff Ø 27
- Handgriep Ø 27
- Impugnatura Ø 27
- Manipulo Ø 27



5 u. **COP2701**

- Coixinet Ø 27
- Cojinete Ø 27
- Coussinet Ø 27
- Bearing Ø 27
- Nylonmuffe Ø 27
- Nylon mof Ø 27
- Cuscinetto Ø 27
- Mancal Ø 27

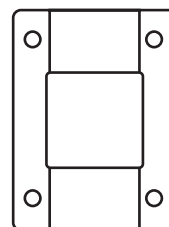

1 u. **LLP2702**

- Lleba llarga Ø 27
- Leva larga Ø 27
- Pêne longue Ø 27
- Long lever Ø 27
- Langer Drehhaken Ø 27
- Lange draaihaak Ø 27
- Chiavistello lungo Ø 27
- Came comprida Ø 27

